

**NOTE:** IN MOST CASES, TRIANGULAR SPACING IS PREFERRED. USE SQUARE SPACING ONLY IN SMALL RECTILINEAR AREAS.

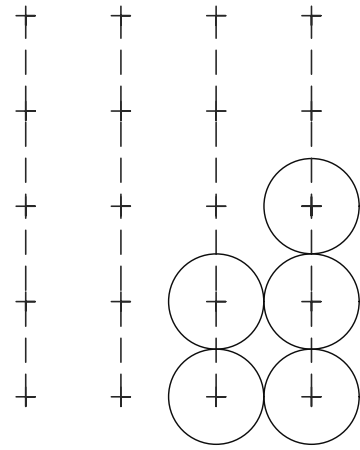

**SQUARE SPACING**

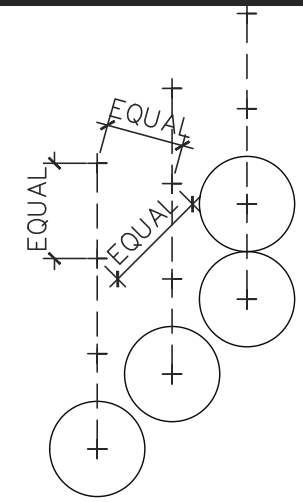

**TRIANGULAR SPACING**

DISTANCE TO CENTERLINE WILL VARY ACCORDING TO SPECIES AND HABITAT OF GROWTH SO THAT MATURE PLANTS WILL NOT OVER LAP ONTO SIDEWALK, STRUCTURES, PAVED AREAS, ETC.

DISTANCE BETWEEN PLANTS SHOULD BE FAR ENOUGH TO ALLOW PLANTS TO REACH MATURE SIZE WITHOUT INTERFERING WITH GROWTH OF ADJACENT PLANT MATERIALS

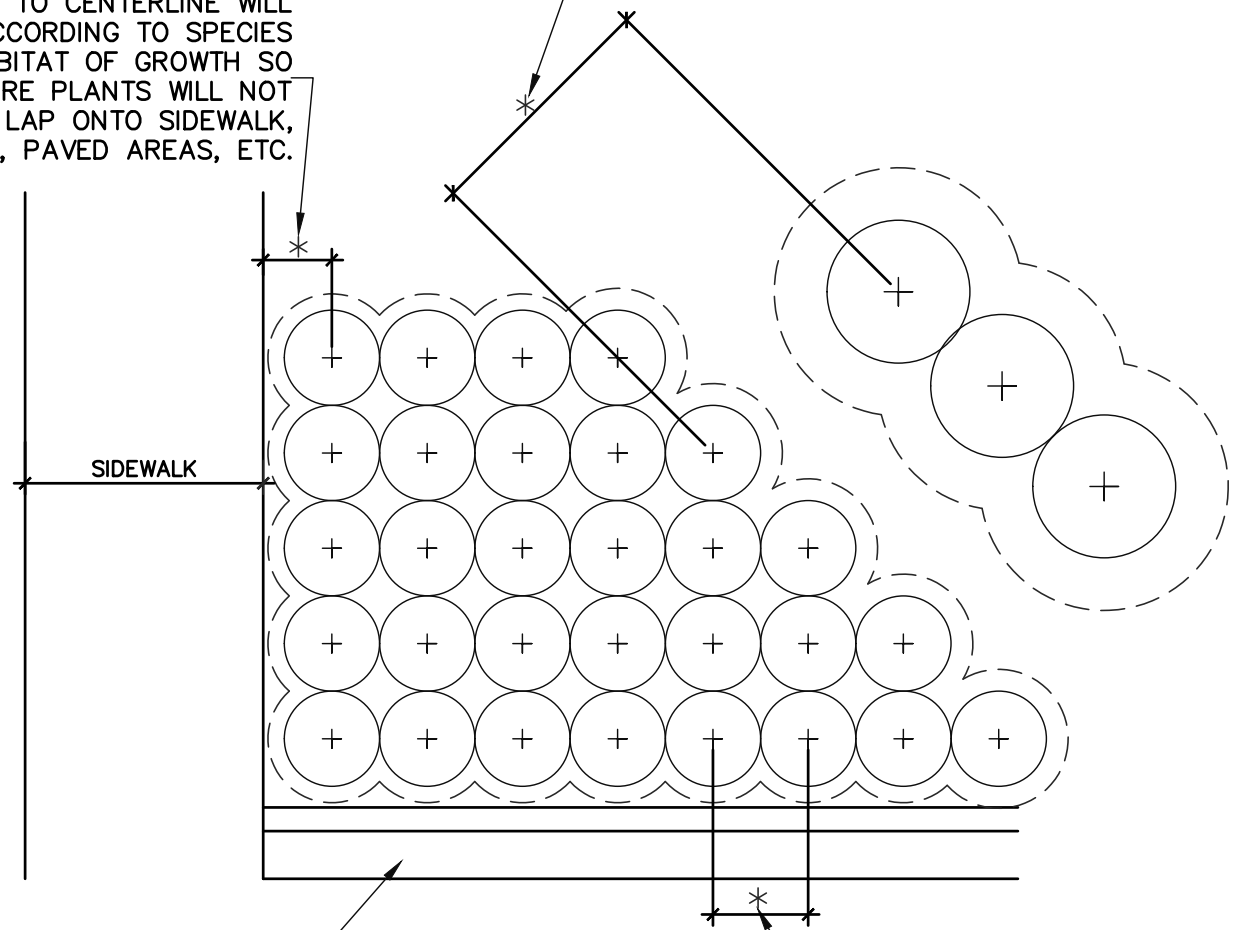

TYPICAL CURB AND GUTTER

SPACING OF PLANTS AS INDICATED ON PLANTING PLAN



**STANDARD CONSTRUCTION DETAIL  
TYPICAL CONTAINER SPACING**

NTS.

INDEX

LS-11

MAY 2020