

TYPICAL PAVEMENT SECTION

NOTE: FOR ROADWAYS, THE CROSS SLOPE SHALL BE 1/4" PER FOOT. FOR PRIVATE PARKING AREAS THE MINIMUM ALLOWABLE PAVEMENT SLOPE SHALL BE NO LESS THAN 0.50% MEASURED FROM THE RECEIVING INLET, GUTTER, OR FLUME TO ANY PAVEMENT.

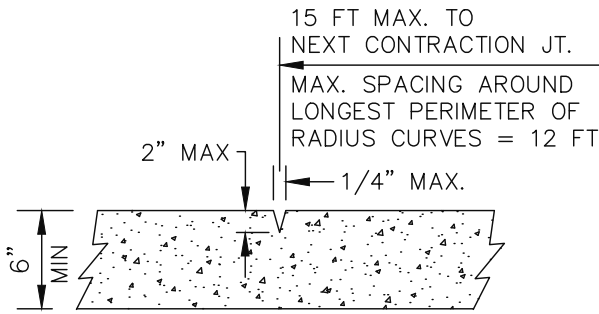

CONTRACTION JOINT

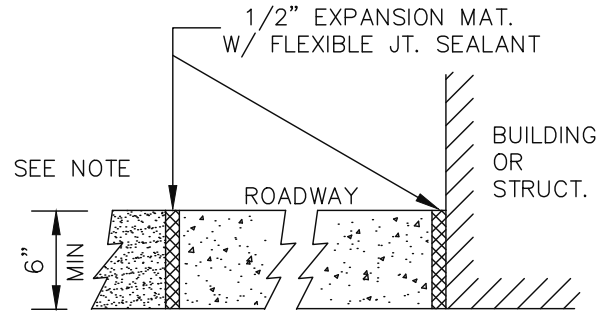

EXPANSION JOINT

NOTES:

1. CONTRACTION JTS. MAY BE HAND FORMED, SAWED OR CONSTRUCTED W/ A 1/4" PREMOLDED FILLER JT. JOINTS MUST BE SAWED BETWEEN 4 AND 18 HOURS AFTER CONCRETE HAS BEEN PLACED.
2. EXPANSION JOINTS TO BE PLACED BETWEEN ROADWAY AND CURB. ALSO AT ANY PERMANENT STRUCTURE ABUTTING OR WITHIN THE PAVED AREA INCLUDING SIDEWALKS.
3. USE OF WOOD IS NOT AN ACCEPTABLE ALTERNATIVE TO FLEXIBLE JOINT SEALANTS.
4. PROPOSED PLAN FOR JOINT LAYOUT FOR EVERY ROADWAY INTERSECTION SHALL BE PROVIDED IN CONSTRUCTION PLANS.
5. FINAL DETERMINATION OF CONSTRUCTION JOINT SELECTION AND APPLICATION SHALL BE MADE BY THE ENGINEER OF RECORD BASED ON PROJECT REQUIREMENTS AND LOCATION.
6. CONSTRUCTION JOINTS WITHIN THE SLAB AREA SHOULD NOT CONTAIN PREMOLDED EXPANSION JOINT FILLER.
7. CONCRETE PAVEMENT CONSTRUCTION SHALL BE IN ACCORDANCE WITH A.C.I. PUBLICATION ACI 330R-87.

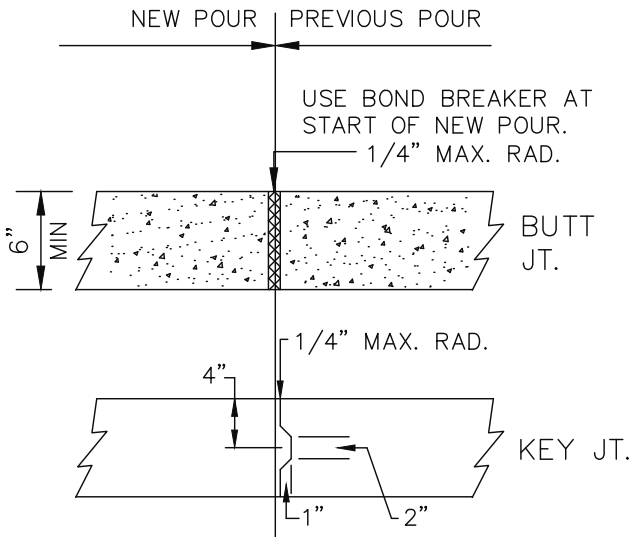

CONSTRUCTION JOINT



STANDARD CONSTRUCTION DETAIL

CONCRETE PAVEMENT DETAILS

NTS

INDEX

R-11A

MAY 2020