

FILL ANNULAR SPACE WITH
EMBECO 167 MORTAR OR
APPROVED EQUAL NON-SHRINK
MORTAR (TYP.)

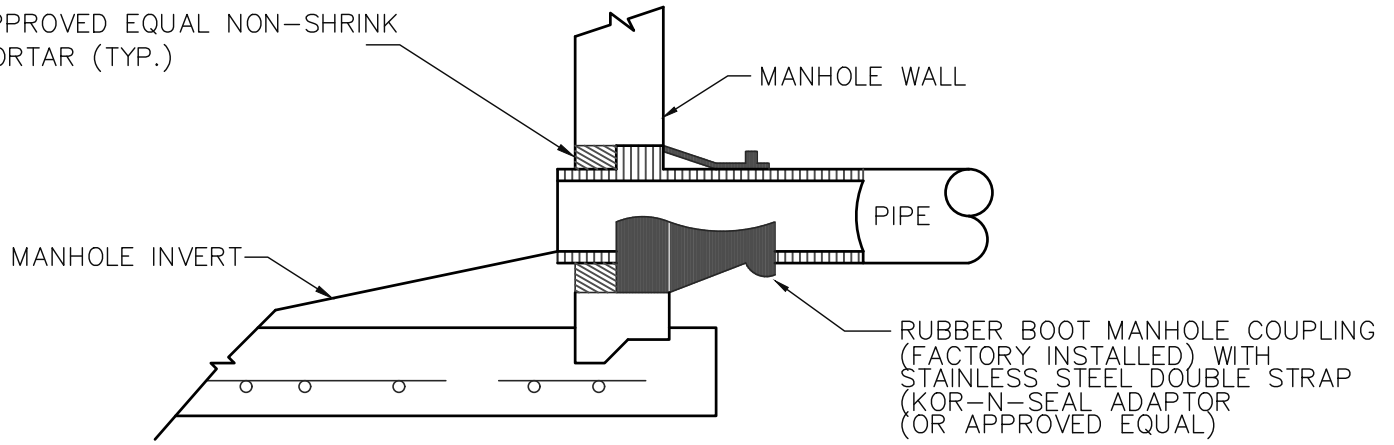

MANHOLE PIPE CONNECTION

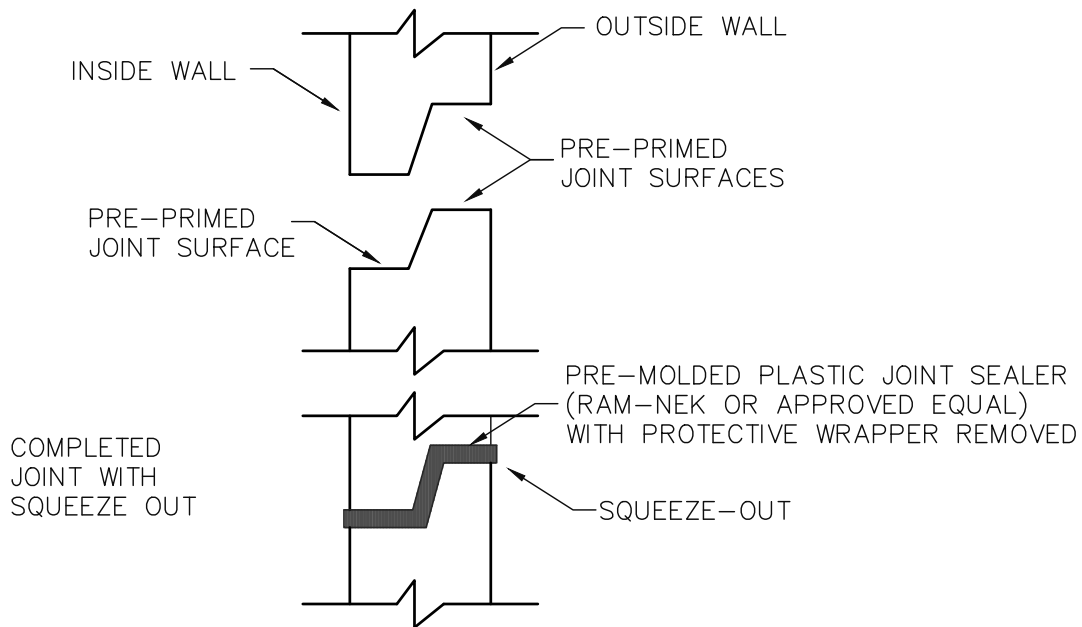

NOTE: ALL CONNECTIONS TO EXISTING SANITARY
SEWER MANHOLES SHALL UTILIZE
A CORING METHOD AND THE IN-FIELD
INSTALLATION OF A RUBBER BOOT
INTO THE MANHOLE AND THEN SECURED
WITH A STAINLESS STEEL DOUBLE STRAP.

PRECAST JOINT CONNECTION

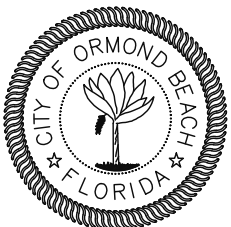

STANDARD CONSTRUCTION DETAIL

RUBBER BOOT AND PRECAST
JOINT CONNECTION DETAIL

NTS.

INDEX

S-5

MAY 2020